

GREENTEETH® SHARPENING GUIDE

Greenteeth®

Sharpen your **Greenteeth®** when:

- The tooth has worn approximately 1/16th of an inch around all edges. (Figure 1.1)
- Production is noticeably reduced.

Sharpening intervals:

- **Greenteeth®** can be sharpened to a minimum of 1/8" (.125") carbide thickness or 1/4" (.250) as measured from the top of the carbide down to the steel shank flat. (Figure 1.2)
- **Greenteeth®** may be sharpened up to 3 times depending on how severe the cutting edges are worn prior to removal.



Figure 1.1

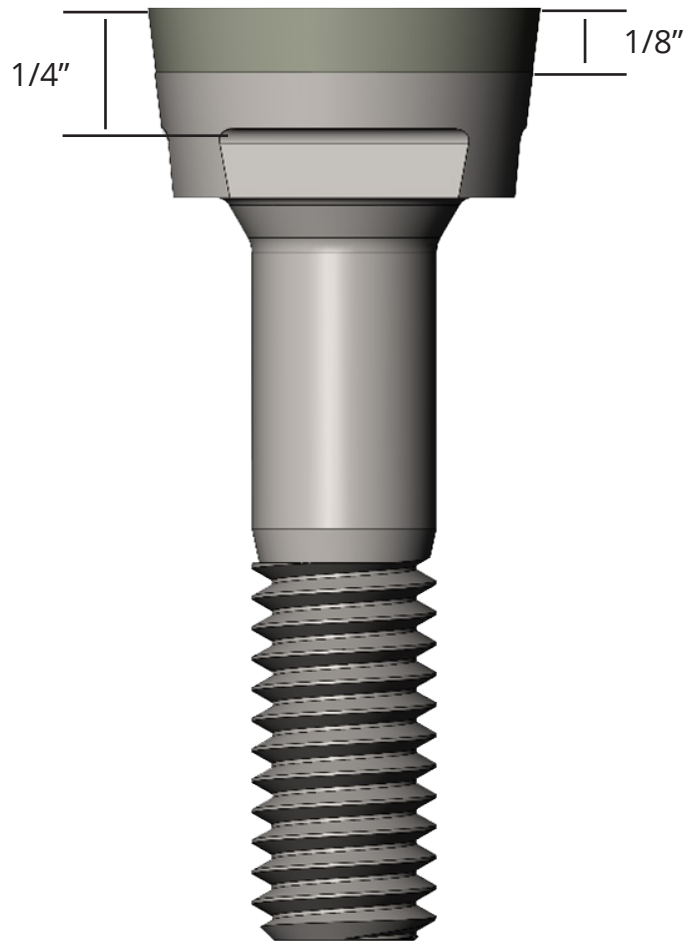

Figure 1.2